

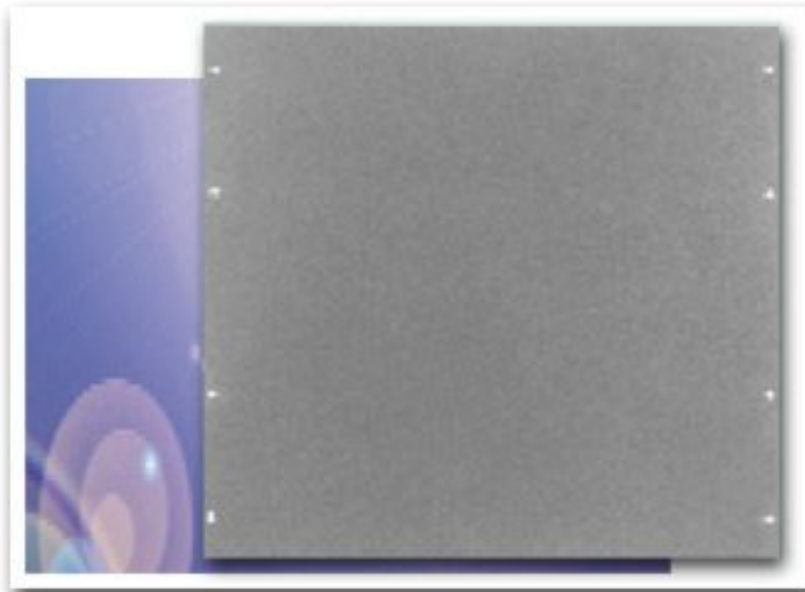

Accessories - Panels
**Surface Shield
 Panels, PA, and PS
 Series**



Standard panels for all cabinets, cabinet racks, relay racks and small enclosures, where applicable.

Design Features

Available in 11 gauge steel and .12" aluminum Alloy. Steel, standard aluminum and hard aluminum (6061-T6) panels come in 19" widths. Standard .12" aluminum panels also available in 24" widths.

Aluminum Panels							
24" Panel 0.12" Thick				19" Panel 0.12" Thick			
Catalog No.	Drawings	Height	Weight Lbs.	Catalog No.	Drawings	Height	Weight Lbs.
PA-2401		1.75"	.50	PA-1131		1.75"	.37
PA-2402		3.50"	1.00	PA-1132		3.50"	.75

PA-2403		5.25"	1.50	PA-1133		5.25"	1.12
PA-2404		7.00"	2.25	PA-1134		7.00"	1.75
PA-2405		8.75"	2.50	PA-1135		8.75"	2.00
PA-2406		10.50"	3.00	PA-1136		10.50"	2.50
PA-2407		12.25"	3.25	PA-1137		12.25"	2.75
PA-2408		14.00"	3.50	PA-1138		14.00"	3.25
PA-2409		15.75"	4.00	PA-1139		15.75"	3.62
PA-2410		17.50"	4.75	PA-1140		17.50"	4.00
PA-2411		19.25"	5.25	PA-1141		19.25"	4.25
PA-2412		21.00"	5.50	PA-1142		21.00"	5.00

Aluminum and Steel Panels							
19" Steel 11 GA.				19" Aluminum 0.12" Thick			
Catalog No.	Drawings	Height	Weight Lbs.	Catalog No.	Drawings	Height	Weight Lbs.
PS-1250		1.75"	1.25	PA-1101		1.75"	.37
PS-1251		3.50"	2.25	PA-1102		3.50"	.75
PS-1252		5.25"	3.25	PA-1103		5.25"	1.12
PS-1253		7.00"	4.50	PA-1104		7.00"	1.75
PS-1254		8.75"	6.00	PA-1105		8.75"	2.00
PS-1255		10.50"	7.00	PA-1106		10.50"	2.50
PS-1256		12.25"	8.25	PA-1107		12.25"	2.75
PS-1257		14.00"	9.50	PA-1108		14.00"	3.25
PS-1258		15.75"	10.75	PA-1109		15.75"	3.62
PS-1259		17.50"	11.75	PA-1110		17.50"	4.00
PS-1260		19.25"	13.00	PA-1111		19.25"	4.25
PS-1261		21.00"	14.25	PA-1112		21.00"	5.00



PART NAME

RELAY RACK PANELS

PART No.

PA-1101 THRU PA-1112 / PS-1250 THRU PS-1261
SFA-1831 THRU SFA-1842

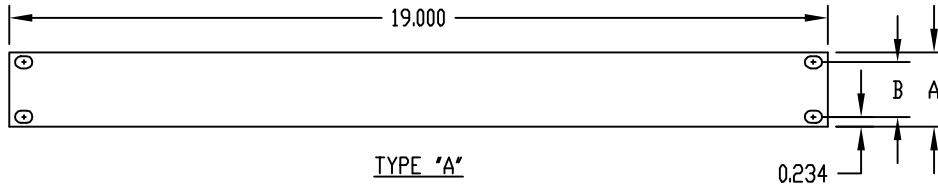

TYPE 'A'

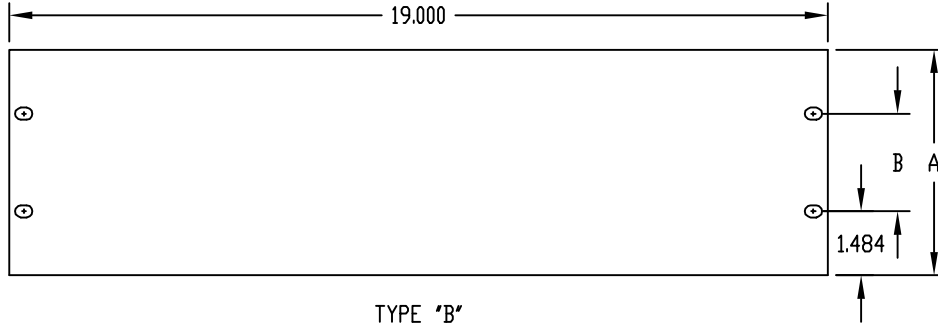

TYPE 'B'

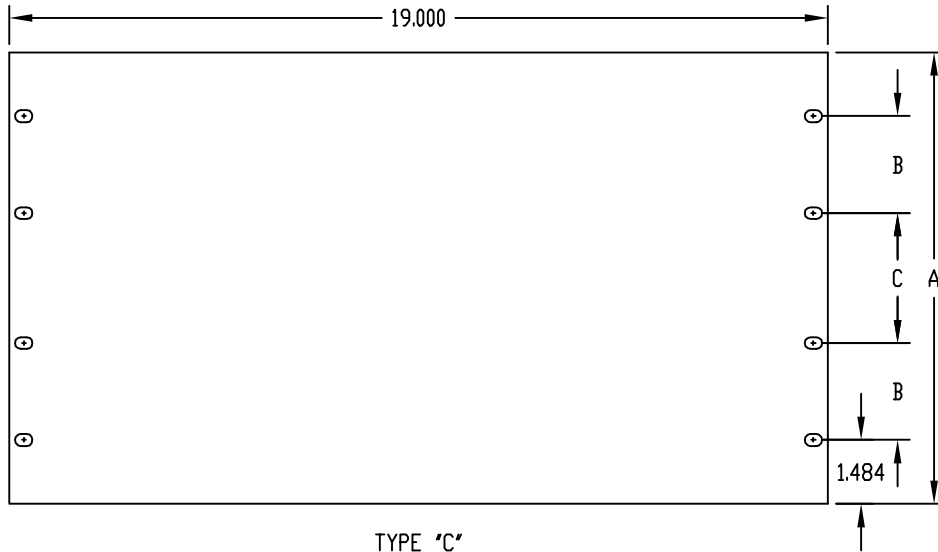

TYPE 'C'

'PA' SERIES:

MATERIAL: 0.125 ALUMINUM
FINISH: METALLIC GRAY
WHITE TEXTURED
BLACK TEXTURED

'PS' SERIES:

MATERIAL: 11 GA. STEEL
FINISH: METALLIC GRAY
WHITE TEXTURED

'SFA' SERIES:

MATERIAL: 0.125 ALUMINUM
ONE SIDE TAPED
FINISH: NATURAL

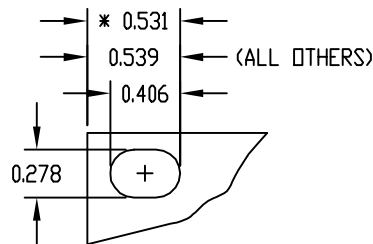

NOTCH DETAIL

* - THIS DIMENSION APPLIES TO ONLY
PA-1101 & PA-1102
SFA-1831 & SFA-1832

'PA' SERIES	'PS' SERIES	'SFA' SERIES	TYPE	A	B	C
PA-1101	PS-1250	SFA-1831	A	1.750	1.250	-
PA-1102	PS-1251	SFA-1832	A	3.500	3.000	-
PA-1103	PS-1252	SFA-1833	B	5.250	2.250	-
PA-1104	PS-1253	SFA-1834	B	7.000	4.000	-
PA-1105	PS-1254	SFA-1835	B	8.750	5.750	-
PA-1106	PS-1255	SFA-1836	C	10.500	2.250	3.000
PA-1107	PS-1256	SFA-1837	C	12.250	3.500	2.250
PA-1108	PS-1257	SFA-1838	C	14.000	4.000	3.000
PA-1109	PS-1258	SFA-1839	C	15.750	4.000	4.750
PA-1110	PS-1259	SFA-1840	C	17.500	4.000	6.500
PA-1111	PS-1260	SFA-1841	C	19.250	5.250	5.750
PA-1112	PS-1261	SFA-1842	C	21.000	5.250	7.500